

2	HARDWARE PACK	1
1	TELESCOPING SECURITY ASSEMBLY	1
PC NO	PART NAME	QTY

CATALOG NUMBER	DESCRIPTION	COLOR
HSE712	7-12 RU TELESCOPING SECURITY ENCLOSURE	BLACK

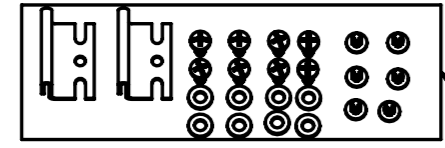

2
HARDWARE BAG-
SECURITY CLIPS &
ASSEMBLY SCREWS

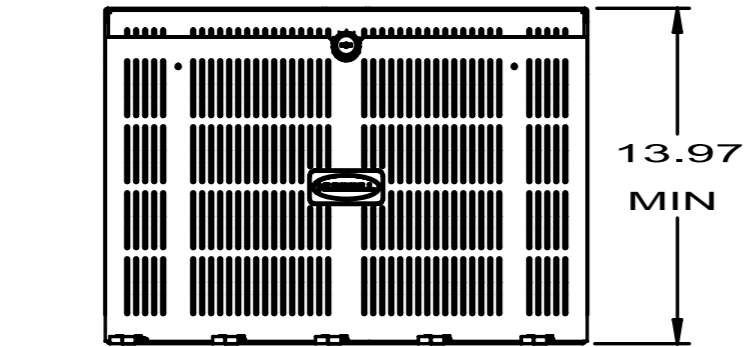

COLAPSED POSITION
OCCUPIES 7RU WITH
6 USABLE RACK UNITS

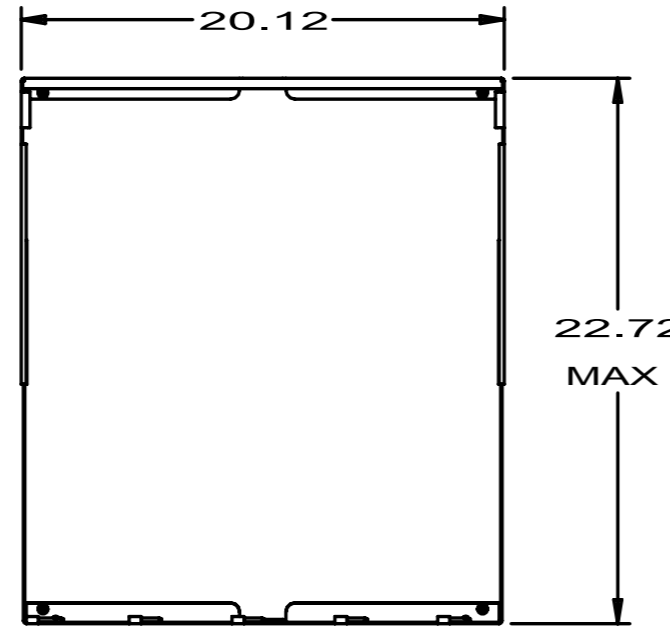

EXPANDED POSITION
OCCUPIES 12RU WITH
11 USABLE RACK UNITS

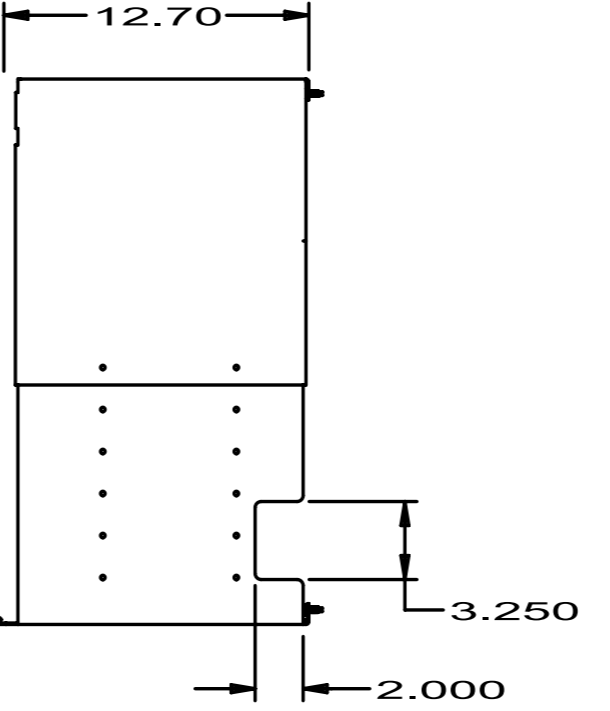

OVER 8RU CABLE ACCESS
HOLE IS AVAILABLE
LEFT & RIGHT SIDE

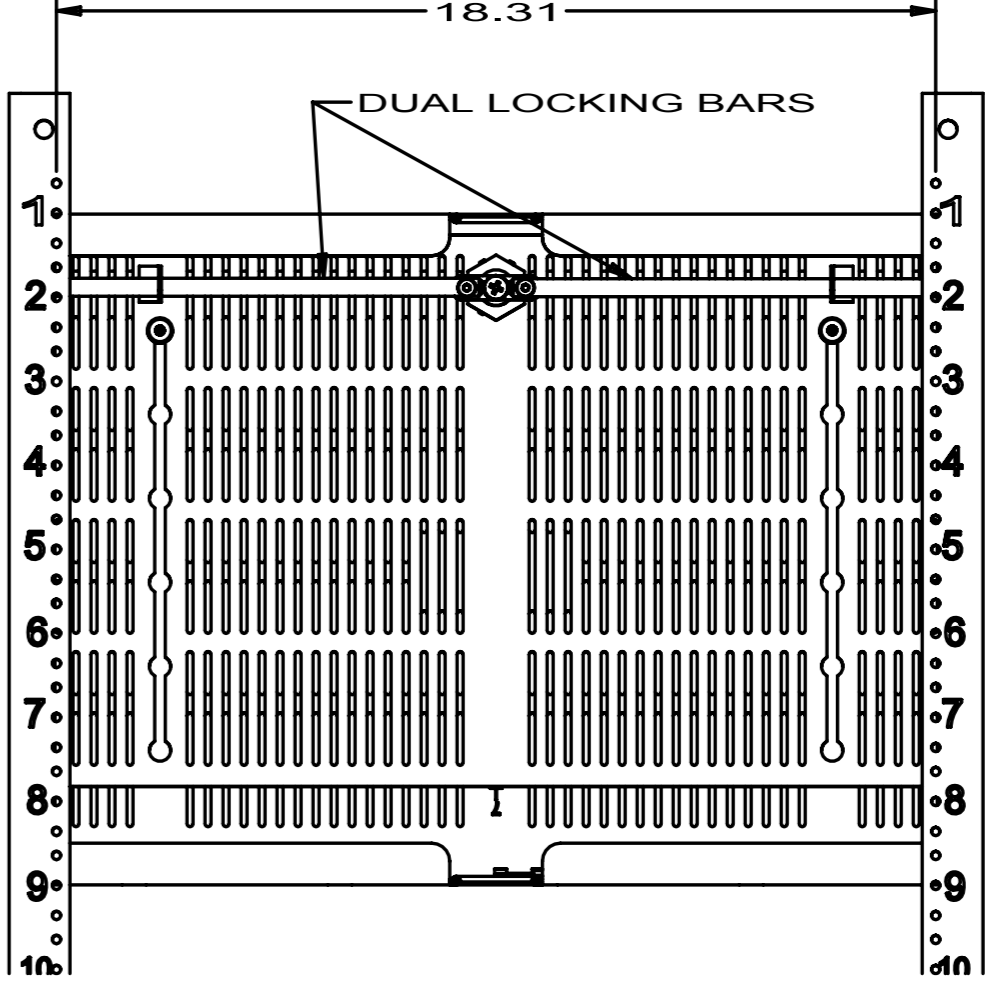

NOTES UNLESS OTHERWISE SPECIFIED:
1. SPECIFICATIONS SUBJECT TO CHANGE WITHOUT NOTICE.

REV.	ECN	DATE	DESCRIPTION	CHG BY	APPD BY
B	19577	1/16/15	UPDATED CABLE OPENING & TAPERED PINS	DMP	
A	19543	10/31/14	INITIAL RELEASE	DMP	

Created on V-13 UNIGRAPHICS

~~DIMENSIONING AND TOLERANCING PER
ANSI Y14.5M-1982.
UNLESS OTHERWISE SPECIFIED,
DIMENSIONS ARE IN INCHES (MM).
TOLERANCES
.XX = ±.01 []
.XXX = ±.005 []
.XXXX = ±.0025 []
ANGLE TOL ±1°~~

IN ACCEPTING OUR DRAWINGS,
BLUEPRINTS, OR SUPPORTING
DOCUMENTATION FOR QUOTATION
OR OTHER PURPOSES, YOU AGREE
NOT TO DISCLOSE TO OTHERS
THE IDEAS, INFORMATION, OR
DESIGNS SHOWN HEREIN, AND
THAT YOU WILL MAKE NO USE
OF SAME WITHOUT PERMISSION.

PROJECT REFERENCE: 2014-003	
MATERIAL:	
DRAWN BY: D. PECK 4/24/14	
CHECKED BY:	
APPROVED BY:	

COMPONENTS CONTAINED IN THIS DOCUMENT MUST ADHERE TO ENVIRONMENTAL SPEC. HWS12367

HUBBELL Hubbell Premise Wiring
HUBBELL INCORPORATED (Delaware)
23 Clara Drive Suite 103, Mystic, Connecticut 06355

TITLE:
TELESCOPING SECURITY ENCLOSURE

SIZE: **C** DRAWING NO.: **HWS14408C** REV.: **B**

SCALE: NTS SHEET 1 of 1